

TE1210ML Mini jack with lock mechanism

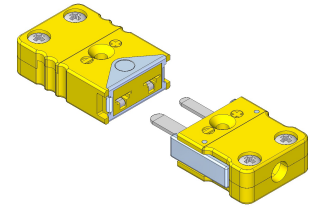

Application

Connector Self locking connector pair for thermocouple and RTD circuits. Locking feature prevents unwanted disconnection due to vibration etc. Suited for small wires and mineral insulated cables.

Construction

Temperature limit Maximum 200°C

Design Rugged one body design

Body material Glass filled high quality thermoplastic body with original thermocouple material pins and springloaded inserts.

Pins Polarized pins ensure proper connection

Molded barriers Prevent short circuit

Termination Stainless Steel screws with Phillips head

Locking mechanism Stainless steel locking clip

Wire size

Accepts wires Accepts wires up to 0.6mm
Maximum cable diameter 4.5mm

Colourcode

Available in all color code standards incl. NFE, BS, JIS, etc

Ordering code

*This datasheet is purely indicative, build-up of model code may vary from this datasheet.

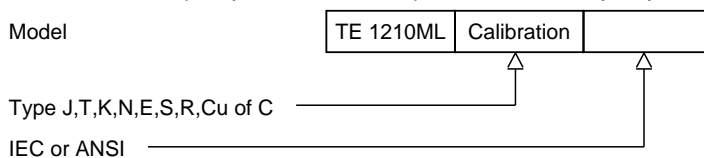

thermo-electra
temperature sensor solutions

Thermo Electra B.V.
Weteringweg 10
2641KM Pijnacker
The Netherlands

Phone +31 (0)15 - 3621200
Fax +31 (0)15 - 3694082
Email sales@thermo.nl
<http://www.thermo-electra.com>

