

# TE1544 Mini panel jack round

## Application

<b>Female panel connector</b>	Thermocouple and RTD circuits
<b>Contacts</b>	Springloaded thermocouple contacts
<b>Materials</b>	Glass filled thermoplastic body with original thermocouple material contacts

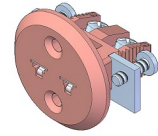

## Temperature rating

<b>Temperature limit</b>	Maximum 220°C
--------------------------	---------------

## Construction

<b>Body</b>	Glass filled thermoplastic material
<b>Design</b>	Stainless steel bracket mounted with 2 screws
<b>Molded barriers</b>	Prevent short circuit

## Wire size

<b>Accepts wires</b>	From 0,2mm. to 2,0mm.
----------------------	-----------------------

## Ordering code

\*This datasheet is purely indicative, build-up of model code may vary from this datasheet.

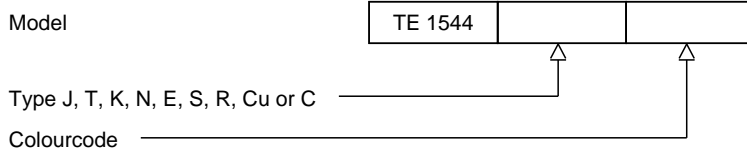

H9-2Rev.0 7/07



**thermo-electra**  
temperature sensor solutions

Thermo Electra B.V.  
Weteringweg 10  
2641KM Pijnacker  
The Netherlands

Phone +31 (0)15 - 3621200  
Fax +31 (0)15 - 3694082  
Email sales@thermo.nl  
<http://www.thermo-electra.com>

