



TE1060D Dual Circuit Plug

Applications

Connector Thermocouple and RTD for duplex circuits
 Contacts Ensuring good contact even in demanding applications
 Materials Glass filled thermoplastic body with original thermocouple material pins

Temperature rating

Temperature limit Maximum 200°C.

Construction

Body Glass filled thermoplastic material
 Design Central cover screw for quick wiring
 Molded barriers Prevent short circuit

Wire size

Accepts wires From 0,2 mm. to 2,0 mm.
 Cable diameter Maximum 8,0 mm

Accessories

Optional accessories See separate datasheet

Color code

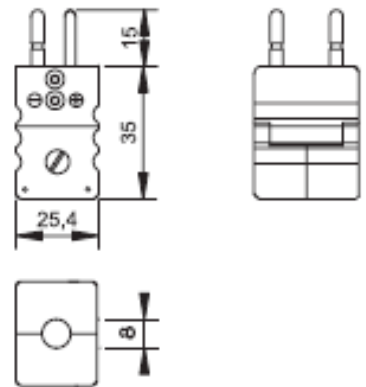

Thermocouple type	T/C Type Code	ANSI Color Code	IEC Color Code
Iron Constantan	J	Black	Black
Copper Constantan	T	Blue	Brown
Chromel Alumel (NiCr-Ni)	K	Yellow	Green
Nicrosil Nisil	N	Orange	Pink
Chromel Constantan	E	Violet	Violet
Platinum 10% Rhodium	S	Green	Orange
Platinum 13% Rhodium	R	Green	Orange
Uncompensated *	Cu	White	White
Tungsten Rhenium	C	Brown	-

* For Pt.6%Rh. / Pt.30%Rh. B type thermocouple and Pt100 sensors

Ordering code

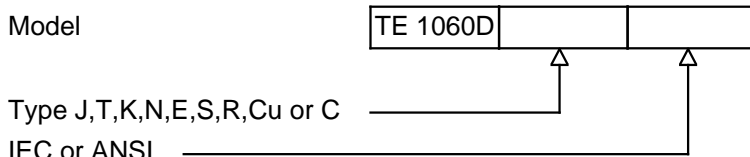

H9-1 Rev.0 7/07



thermo-electra
 measurement and control technics

PO BOX 73
 2640 AB Pijnacker
 The Netherlands

Phone +31 (0)15 - 3621200
 Fax +31 (0)15 - 3694082
 Email sales@thermo.nl
 Internet http://www.thermo-electra.com